

LD153

High Power Exterior LED Uplighter

Data sheet - Page 1



Design: Green Leaf Lighting Design Project: Private Residence Product: LD151

A very powerful uplighter for its size and depth. The LD153 has been designed specifically to produce low glare illumination to exterior walls and columns in public areas. The 4 screws in the front allow it to be locked into the mounting surface using a very clever O-ring compression system. This is a very tough, high quality fitting, machined from high grade materials ensuring excellent thermal and light output performance.

Key Features

- LED and lens assembly recessed within a black anodised body for reduced glare
- Glare shield developed to minimise the view of the intense light source without affecting the wash of light on the wall/column
- Single optic produces a very consistent beam with no multiple shadows
- Tight 10° spot is available for lighting columns and arches or a 15°x 30° spreader lens which is ideal for wall washing
- 4 screws in the bezel are tightened to expand O-rings on the body and secure it into the first fix sleeve, or concrete housing, creating a water tight seal
- RGBW LED option uses a larger optic, for a premixed light beam immediately adjacent to the fitting
- Available with Switch, 1-10V, DMX, Dali or Mains dimmable drivers

Design tip: For a screwless version the LD151 has the same output, and uses the same LED and optics as the LD153.



Specification

Applications				
Beam Angles	10°, 15°x 30°			
LED type	1 x Cree MKR 4 die LED with 2 Step Easy White binning			
Colour temperature	2700K / 3000K / 4000K		5000K	
Current	350mA	500mA	350mA	500mA
LED power (Max)	5W (4.4W)*	7W (6.3W)*	5W (4.4W)*	7W (6.4W)*
CRI (Min)	85	85	80	80
Forward voltage (Max)	14V	14V	14V	14V
Delivered lumens (L ₁₀₀)**	307	416	330	445
Lumens per circuit watt	70	66	75	71
LED lifetime (to 70% lumen maintenance)	50,000hrs at a max ambient temperature of 35°C (if higher ambient then run at 350mA up to 45°C)			
Glass	6mm thick borosilicate			
Materials	Black anodised aluminium body, Machine finish 316 stainless steel bezel (other options available)			
Wiring	Comes pre-wired with 2 core 250mm lead. Can be specified with up to 10m at extra cost.			
IP rating	IP67			
*indicates the nominal power for the LED run at that particular current and includes losses associated with using an 85% efficient driver				
**lumen output indicated is without the glare shield. Allow 30% less with glare shield.				

LD153

High Power Exterior LED Uplighter



Data sheet - Page 2

Dimensions & Fixing Options

- The LD153 must be used with one of these fixing options

/483S First fix sleeve is polypropelene, with a finned top to fix into various surfaces.

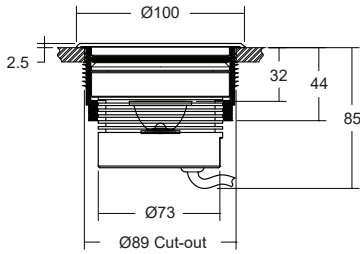

/483N Concrete Housing
/ID Optional integral non dimming driver (single colour only)

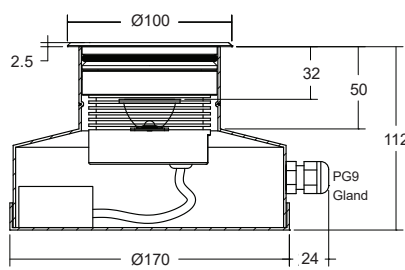

Fixing Mechanism

Fitting pushed into housing



Orientate fitting. Then tighten 4 screws



Ring is pulled up and expands the O ring, locking fitting into the housing

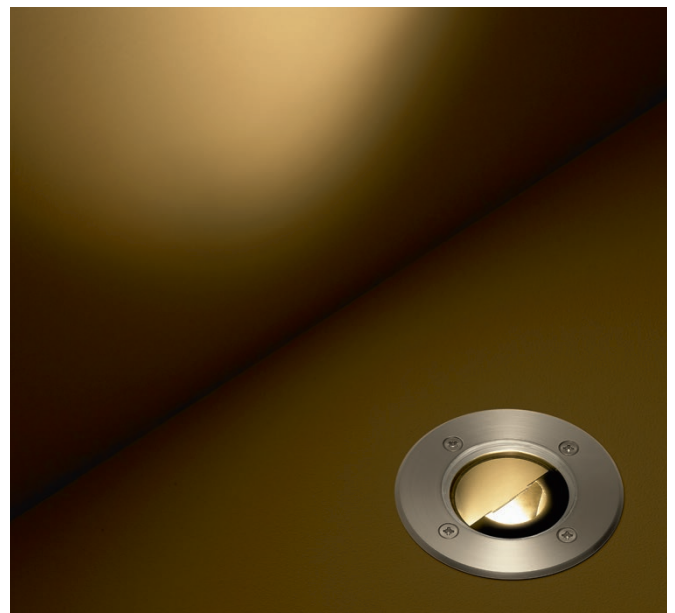

LD153

High Power Exterior LED Uplighter

Data sheet - Page 3



Lens Options

/NB - 10° spot

/OB - 15°x 30°
 spreader

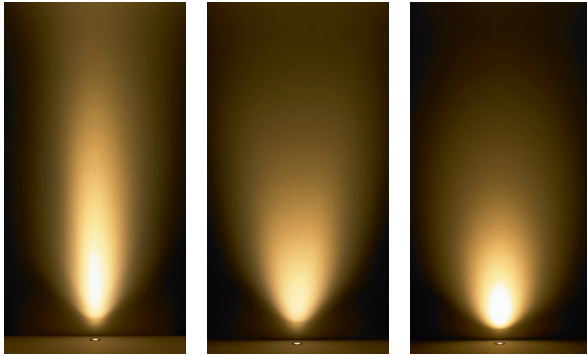
 RGBW - 26deg
 colour mix

The centre of the LD153 is positioned 125mm from the wall (2.5m high) in these photos.

Photometrics

Photometric files are included in the design pack which can be downloaded from the LD153 product page on the website.

Order Codes and Options

Product code	LED colour	Lens angle	Bezel finish	Accessory
LD153 - 350 - 500	<input type="text"/>	<input type="text"/>	<input type="text"/>	<input type="text"/>

Example: LD153-350 / LW30 / NB / Stainless Steel / 483N

Product codes with output options

5W 350mA	LD153-350
7W 500mA	LD153-500

LED colour options

	Suffix
Extra Warm White (2700K)	/LW27
Warm White (3000K)	/LW30
White (4000K) - on request	/LW40
Cool White (5000K)	/LW50
RGBW (4000K White)	/RGBW

Beam / lens angle options

10° narrow spot	/NB
15° x 30° oval spreader beam	/OB
RGBW LED comes with a 26° lens	

Bezel finish options

Stainless steel 316
 Paint finish white / black / RAL
 Polished and passivated stainless steel (for marine environments)
 Flamed solid bronze* (antique finish) * To minimum order quantities

Fixing accessories

First fix sleeve	/483S
Concrete housing	/483N
with integral driver	/ID

Use with 350mA and 500mA constant current LED drivers

 For our complete range of LED drivers please download the data sheet from the downloads section at www.lightgraphix.co.uk
